

Cranchi Z35 (yard nr. 7862)

399.000,00 € (exl. VAT)



SPECIFICATIONS:

<i>Length overall approx.</i>	11,70 m	<i>Engines</i>	2 Volvo Penta D4 540 hp
<i>Length hull approx.</i>	9,99 m	<i>Working hours</i>	59
<i>Beam max approx.</i>	3,53 m	<i>Passengers and weight approx.</i>	12/1.140 kg
<i>Draft (incl.props) approx.</i>	1,00 m	<i>Fuel capacity approx.</i>	600 l
<i>Dry weight (without engines) approx.</i>	7.250,00 kg	<i>Fresh water capacity approx.</i>	190 l

STANDARD EQUIPMENT

Water distribution system directly from the dock	Roll-up foldaway hose
Fire extinguisher: n°2 automatic in engine room + n°1 manual in the cockpit	Acoustic and visual alarm on the dashboard for water in the bilge
Bruce anchor 15 kg	Engine/on-board service batteries n°3
Interior Deluxe version	Magnetic compass
Water heater I 25	Automatic battery charger 35 Ah 3 output
50 meters - 8mm chain	Antiflame blanket
Volvo Penta blade trim tabs	Bow sunbathing cushion + storage + cover
Cockpit shower	Bow shower
Easy connect Volvo Penta	Grey water: shower collection system
Cabin fridge I 65	Electric system 12V/DC 230V/AC
Additional external courtesy lights	Boat hook
Saloon floor in wood pre-treated anti-scratch and anti-mold	Upgrade radio - Speakers on the foredeck + Subwoofer
Stainless steel aft fender holders n°6	Shore power 32Ah with cable
RADIO Fusion with control in the cockpit	Water pump
Teak cockpit table convertible in sunbathing including cushion	Foldable saloon table



ALBERTA YACHTS

Ulica grada Vukovara 269A, HR-10 000 Zagreb

OIB: HR69675832431

Bank details: Addiko bank d.d. IBAN HR5925000091101262502

Teak laid part of the cockpit
Mosquito nets on portholes
Hydraulic steering and electronic engines control
Electric marine WC

Cabins' curtains
Windscreen wiper
Electric winch 800W
Mosquito net - blind on deck hatch bow cabin

EXTRA EQUIPMENT

Volvo Penta 2xD4 EVC/E/DPI (2x270 HP) (2x199kW)

Bilge micro suction system
Ultramarine stainless steel anchor kg16
Air conditioning system 16.000 BTU, with heat pump
Complete hood (with bimini)
Microwave oven
GPS/colour chartplotter Garmin display 10"
Underwater lights n.3
Multi-instrument DTS (depth-temperature-speed)
integrated in the helm position instruments
N°6 fenders + fender covers
Solid teak coverings on lateral stringers
Teak laid cockpit
Hood: alternative colour to standard one
Anchor winch remote control with integrated anchor
meter counter

JOYSTICK + Cruise control + Single lever control + Trip
Computer + Power trim assistance
Waste water tank
Antifouling black colour, n.2 coats (no propellers)
N.2 saloon roof window blinds
Bow thruster with automatic fire extinguisher
Cockpit fridge - new model
3,5 KW Generator -22 hours
V.H.F./DSC Garmin
Set of Cranchi® crockery, cutlery and glasses (6
settings)
Autopilot Garmin
Teak laid swimming platform
Copy of "CE" certificate and declaration of conformity
Builder's certificate

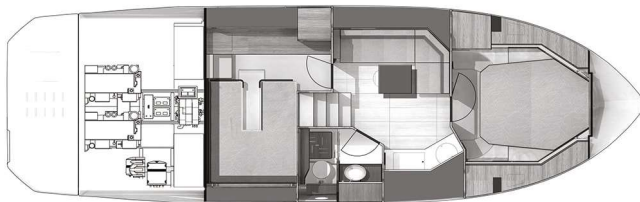
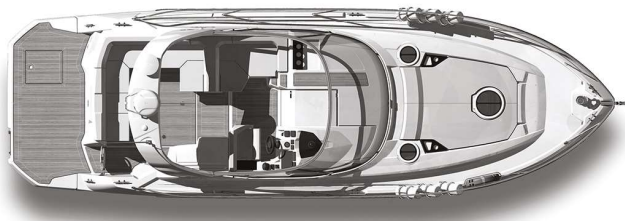

ALBERTA YACHTS

Ulica grada Vukovara 269A, HR-10 000 Zagreb

OIB: HR69675832431

Bank details: Addiko bank d.d. IBAN HR5925000091101262502



ALBERTA YACHTS

Ulica grada Vukovara 269A, HR-10 000 Zagreb

OIB: HR69675832431

Bank details: Addiko bank d.d. IBAN HR5925000091101262502